

EN1092-1/11B PN40

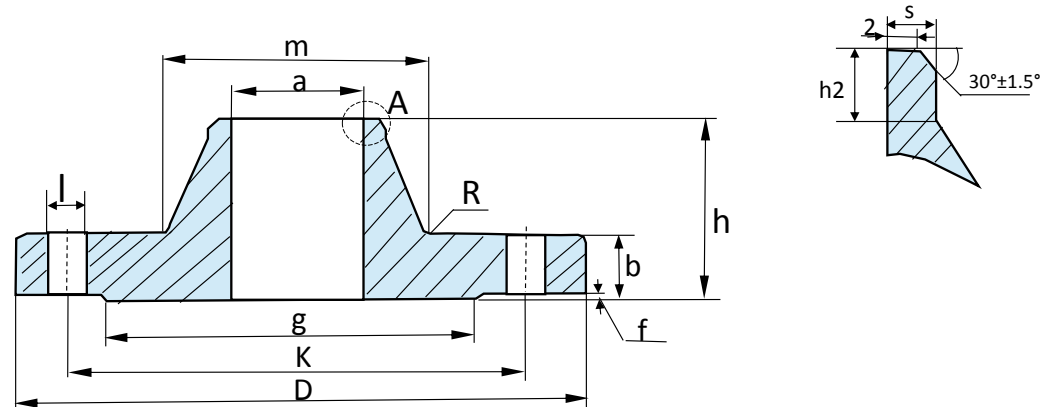

| Pipe Nominal size | Flange | | | | | Neck | | | | Raised face | | Screws | | | Weight kg |
|-------------------------|--------|-----|----|-----|-----|------|------|----|----------------|-------------|---|--------------|--------|----|--------------|
| | a | D | b | k | h | m | s | r | h ₂ | g | f | No. of holes | Thread | l | |
| 2 | 60.32 | 165 | 20 | 125 | 48 | 75 | 2.9 | 6 | 8 | 102 | 3 | 4 | M16 | 18 | 2.85 |
| 2.50 | 73.03 | 185 | 22 | 145 | 52 | 90 | 2.9 | 6 | 10 | 122 | 3 | 8 | M16 | 18 | 3.68 |
| 3 | 88.90 | 200 | 24 | 160 | 58 | 105 | 3.2 | 8 | 12 | 138 | 3 | 8 | M16 | 18 | 4.78 |
| 4 | 114.30 | 235 | 24 | 190 | 65 | 134 | 3.6 | 8 | 12 | 162 | 3 | 8 | M20 | 22 | 6.46 |
| 5 | 141.30 | 270 | 26 | 220 | 68 | 162 | 4 | 8 | 12 | 188 | 3 | 8 | M24 | 26 | 8.86 |
| 6 | 168.28 | 300 | 28 | 250 | 75 | 132 | 4.5 | 10 | 12 | 218 | 3 | 8 | M24 | 26 | 11.7 |
| 8 | 219.08 | 375 | 34 | 320 | 88 | 244 | 6.3 | 10 | 16 | 285 | 3 | 12 | M27 | 30 | 21 |
| 10 | 273.05 | 450 | 38 | 385 | 105 | 306 | 7.1 | 12 | 18 | 345 | 3 | 12 | M30 | 33 | 34.2 |
| 12 | 323.85 | 515 | 42 | 450 | 115 | 362 | 8 | 12 | 18 | 410 | 4 | 16 | M30 | 33 | 47.6 |
| 14 | 355.60 | 580 | 46 | 510 | 125 | 408 | 8.8 | 12 | 20 | 465 | 4 | 16 | M33 | 36 | 69.3 |
| 16 | 406.40 | 660 | 50 | 585 | 135 | 462 | 11 | 12 | 20 | 535 | 4 | 16 | M36 | 39 | 98 |
| 18 | 457.20 | 685 | 57 | 610 | 135 | 500 | 12.5 | 12 | 20 | 560 | 4 | 20 | M36 | 39 | 105 |
| 20 | 508.00 | 755 | 57 | 670 | 140 | 562 | 14.2 | 12 | 20 | 615 | 4 | 20 | M39 | 42 | 130 |