

EN1092-1/11B PN16

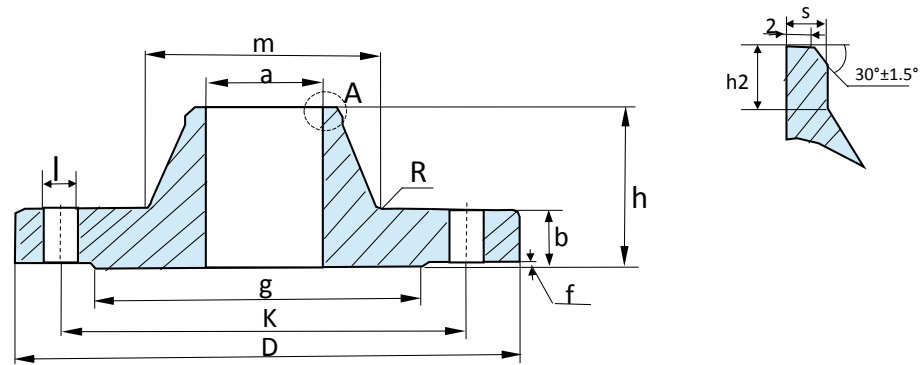

Pipe		Flange				Neck				Raised face		Screws			Weight
DN	a	D	b	k	h	m	s	r	h2	g	f	No. of holes	Thread	l	kg
15	21.3	95	16	65	38	32	2	4	6	45	2	4	M12	14	0.768
20	26.9	105	18	75	40	40	2.3	4	6	58	2	4	M12	14	1.09
25	33.7	115	18	85	40	46	2.6	4	6	68	2	4	M12	14	1.3
32	42.4	140	18	100	42	56	2.6	6	6	78	2	4	M16	18	1.91
40	48.3	150	18	110	45	64	2.6	6	7	88	3	4	M16	18	2.15
50	60.3	165	18	125	45	74	2.9	6	8	102	3	4	M16	18	2.53
65	76.1	185	18	145	45	92	2.9	6	10	122	3	4	M16	18	3.12
65	76.1	185	18	145	45	92	2.9	6	10	122	3	8	M16	18	3.03
20	88.9	200	20	16	50	105	3.2	6	10	138	3	8	M16	18	3.92
100	114.3	220	20	180	52	131	3.6	8	12	158	3	8	M16	18	4.62
125	139.7	250	22	210	55	156	4	8	12	188	3	8	M16	18	6.3
150	168.3	285	22	240	55	184	4.5	10	12	212	3	8	M20	22	7.81
200	219.1	340	24	295	62	235	6.3	10	16	268	3	12	M20	22	11.5
250	273	405	26	355	70	292	6.3	12	16	320	3	12	M24	26	16.7
300	323.9	460	28	410	78	344	7.1	12	16	378	4	12	M24	26	22.1
350	355.6	520	30	470	82	390	8	12	16	438	4	16	M24	26	32.8
400	406.4	480	32	525	85	445	8	12	16	490	4	16	M27	30	41.1
450	457	640	34	285	83	430	8	12	16	550	4	20	M27	30	48.5
500	508	715	36	650	84	548	8	12	16	610	4	20	M30	33	63.4
600	610	840	40	770	88	670	10	12	18	725	5	20	M33	36	96