

Socket Weld Straight Tees

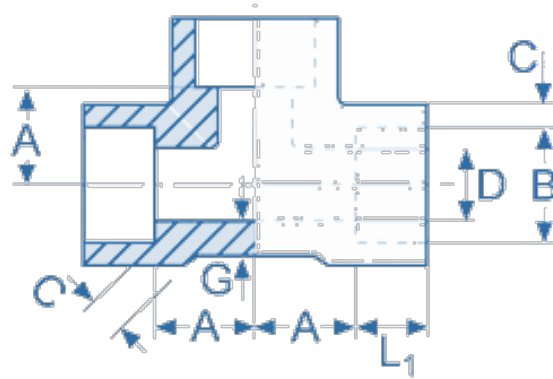

ASTM A182 3000lb ASME B16.11/BS3799

Nominal pipe size	B	L1	C	G	D	A	Weight	ASTM	ASTM
in.	mm	socket	mm	mm	mm	mm	kg	304/304L	316/316
¼	14.20	9.53	3.30	3.02	8.86	11.11	0.11	•	•
⅜	17.60	9.53	3.51	3.20	12.14	13.49	0.16	•	•
½	21.80	9.53	4.09	3.73	15.42	15.88	0.34	•	•
¾	27.20	12.50	4.27	3.91	20.55	19.05	0.41	•	•
1	33.90	12.50	4.98	4.55	26.26	22.23	0.65	•	•
1¼	42.70	12.50	5.28	4.85	34.67	26.99	0.95	•	•
1½	48.80	12.50	5.54	5.08	40.51	31.75	1.33	•	•
2	61.20	16.00	6.05	5.54	52.12	38.10	2.20	•	•

•= stock standard