

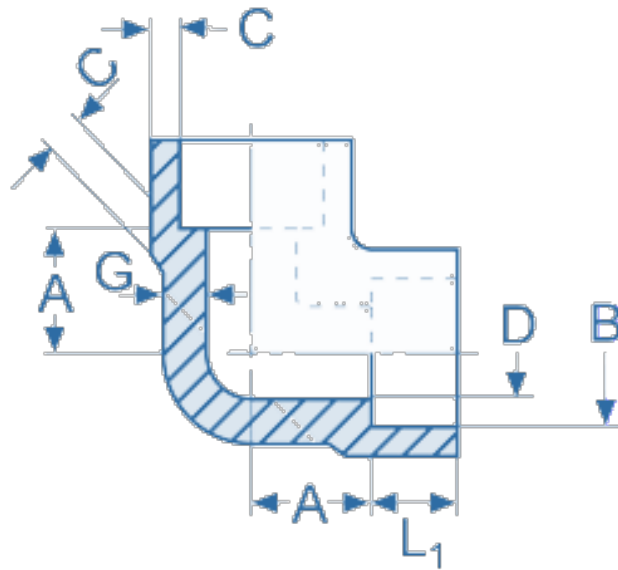

## Socket Weld Elbows 90°



**ASTM A182 3000lb ASME B16.11/BS3799**

Nominal pipe size	B	L1	C	G	D	A	Weight	ASTM	ASTM
<b>in.</b>	mm	socket	mm	mm	mm	mm	kg	304/304L	316/316
<b>¼</b>	14.20	9.53	3.30	3.02	8.86	11.11	0.09	•	•
<b>⅜</b>	17.60	9.53	3.51	3.20	12.14	13.49	0.13	•	•
<b>½</b>	21.80	9.53	4.09	3.73	15.42	15.88	0.25	•	•
<b>¾</b>	27.20	12.50	4.27	3.91	20.55	19.05	0.32	•	•
<b>1</b>	33.90	12.50	4.98	4.55	26.26	22.23	0.52	•	•
<b>1¼</b>	42.70	12.50	5.28	4.85	34.67	26.99	0.86	•	•
<b>1½</b>	48.80	12.50	5.54	5.08	40.51	31.75	1.12	•	•
<b>2</b>	61.20	16.00	6.05	5.54	52.12	38.10	1.80	•	•

•= stock standard

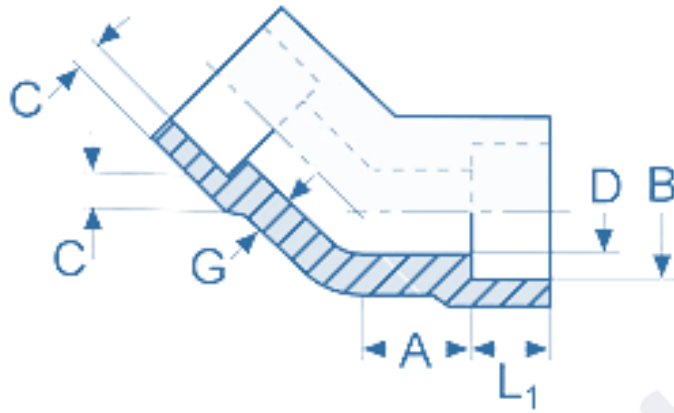

**ASTM A182 3000lb ASME B16.11/BS3799**

Nominal pipe size	B	L1	C	G	D	A	Weight	ASTM	ASTM
<b>in.</b>	mm	socket	mm	mm	mm	mm	kg	304/304L	316/316
<b>¼</b>	14.20	9.53	3.30	3.02	8.86	7.94	0.09	•	•
<b>⅜</b>	17.60	9.53	3.51	3.20	12.14	7.94	0.13	•	•
<b>½</b>	21.80	9.53	4.09	3.73	15.42	11.11	0.18	•	•
<b>¾</b>	27.20	12.50	4.27	3.91	20.55	12.70	0.30	•	•
<b>1</b>	33.90	12.50	4.98	4.55	26.26	14.29	0.45	•	•
<b>1¼</b>	42.70	12.50	5.28	4.85	34.67	17.46	0.75	•	•
<b>1½</b>	48.80	12.50	5.54	5.08	40.51	20.64	0.90	•	•
<b>2</b>	61.20	16.00	6.05	5.54	52.12	25.40	1.30	•	•

•= stock standard