

Butt Weld Carbon Straight Tee

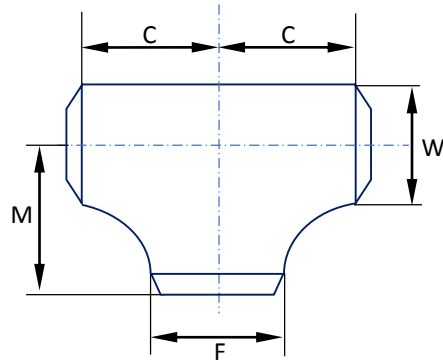

Nominal pipe size	W (mm)	F (mm)	M (mm)	C (mm)	Approx. Wt. (Kg)		
					STD	S40	XS
1/2	21,3	21,3	25,0	25,0	0,10		0,13
3/4	26,7	26,7	29,0	29,0	0,16		0,19
1	33,4	33,4	38,0	38,0	0,32		0,40
1-1/4	42,2	42,2	48,0	48,0	0,52		0,70
1-1/2	48,3	48,3	57,0	57,0	0,75		1,03
2	60,3	60,3	64,0	64,0	1,09		1,49
2-1/2	73,0	73,0	76,0	76,0	2,00		2,54
3	88,9	88,9	86,0	86,0	2,83		3,81
3-1/2	101,6	101,6	95,0	95,0	3,85		5,00
4	114,3	114,3	105,0	105,0	4,81		6,80
5	141,3	141,3	124,0	124,0	7,27		10,19
6	168,3	168,3	143,0	143,0	10,20		16,20
8	219,1	219,1	178,0	178,0	19,63		28,79
10	273,0	273,0	216,0	216,0	33,63		45,60
12	323,8	323,8	254,0	254,0	47,72	49,10	